



Maximum Weight Capacity 205KG

1 Product description:

This ceiling hoist is intended for lifting children and adults up to 200kg. This equipment must not be used for any other purpose.

2 Pre use checks:

Hold and pull the carry bar, moving the hoist to an area free of obstructions. Take care to familiarise yourself with the functions and controls (see fig 1).

3 Instructions for use

The hoist is controlled via the hand control (see fig 2). Do not pull the hand control with force. When the hand control is not in use, clip over the carry bar. Keep all obstructions clear during lifting.

4 Slings

This hoist is designed for use with loop style slings only. If unsure do not use your sling.

5 Trouble shoot

If the hoist is not working check to see if the emergency stop cord has been pulled into the down position, disabling the hoist (see fig 3).

To re-enable push white clip, attached to the top of the red cord, up toward the hoist. If unable to reach use the carry bar.

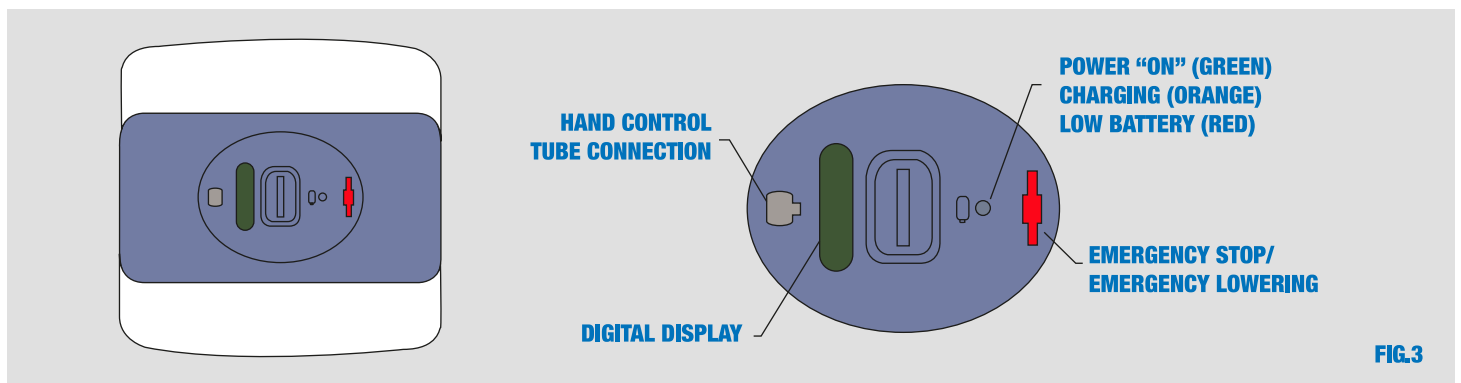
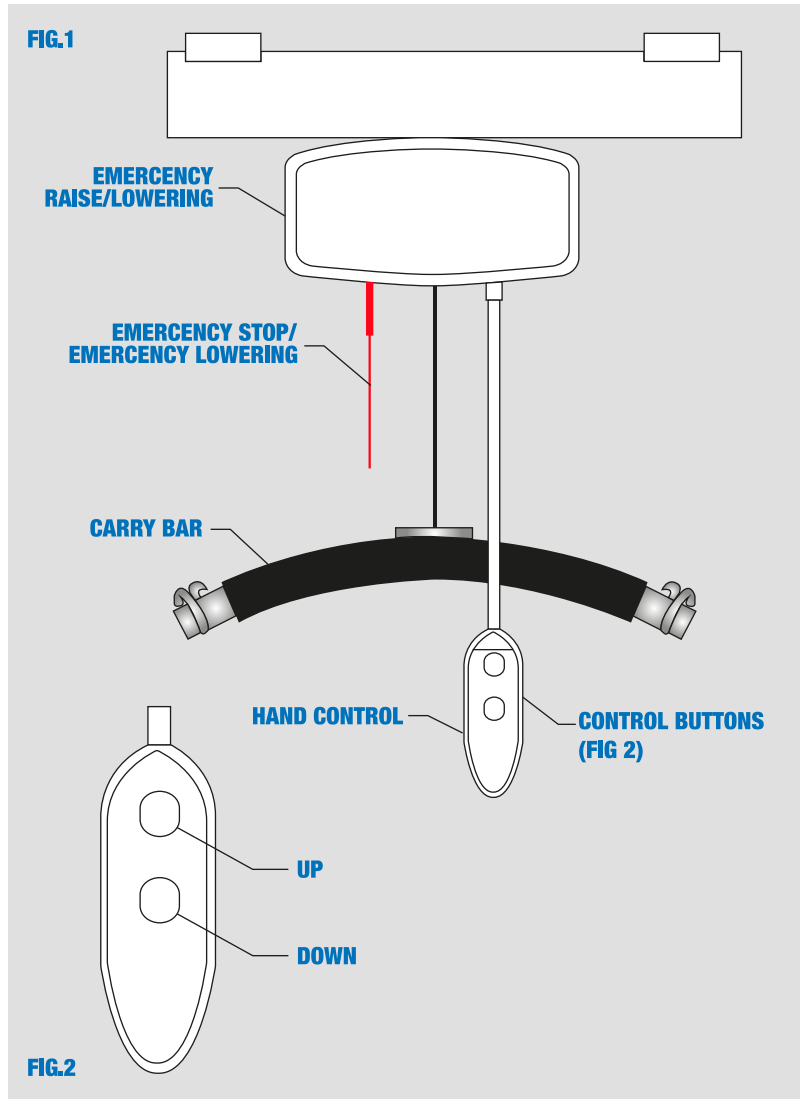

6 Emergency lowering

If the hoist becomes stuck or won't lower, pull the red cord and press the down button on the hand control simultaneously to lower the carry bar to the desired height. Use this function only in an emergency.

Ceiling Hoist Help Guide



**Changing Places
Transforming Lives**

proudly supported by  **CHS Healthcare**

1 The Ceiling Hoist - what to do and how it works



- Hold and use the spreader bar to pull the hoist into a clear area for safe use. Make sure there are no obstructions around you
- Take care to familiarise yourself with the features of this hoist

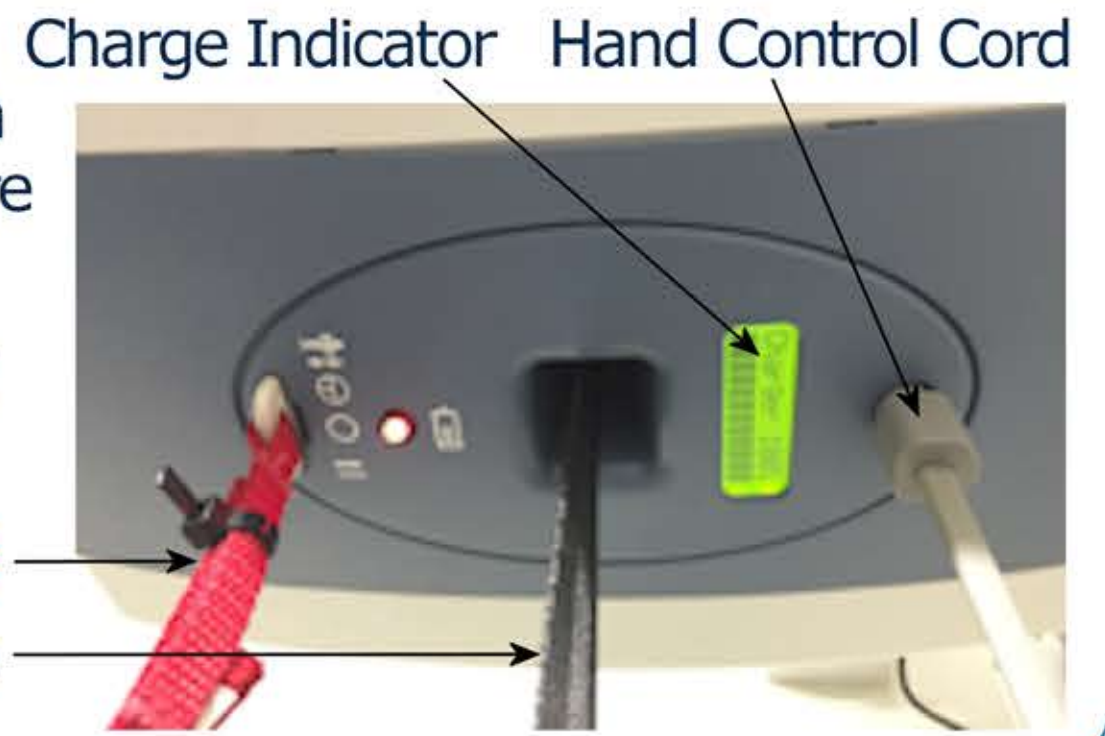

Spreader bar

2 The hand control, spreader bar and your sling

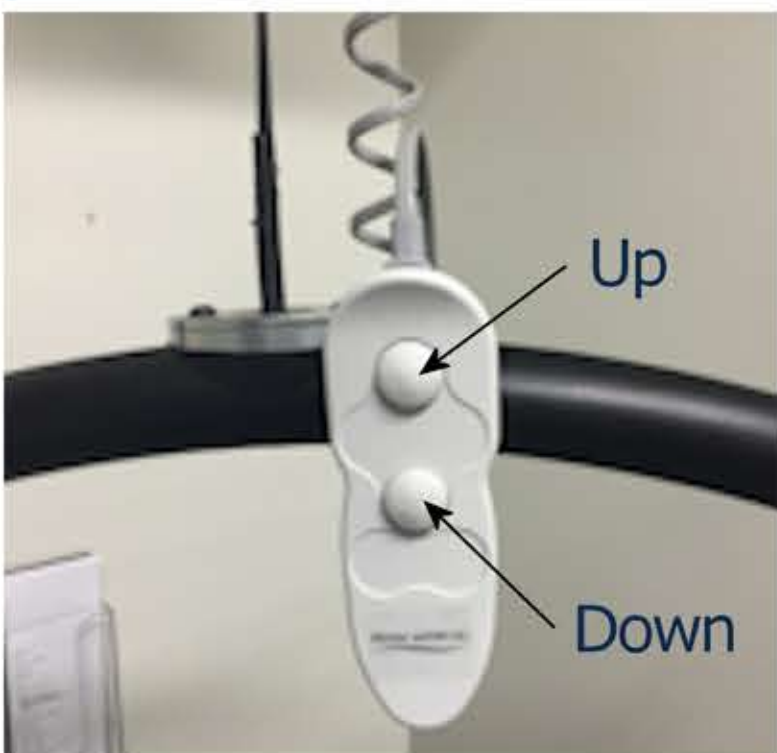

- The hoist has 2 buttons - up and down
- Do not pull hard on the hand control cord
- When the hand control is not in use clip the hand control over the spreader bar (left) to keep it safely out of the way
- Keep all obstructions clear when lifting



Loop style slings only

3 If the hoist doesn't work

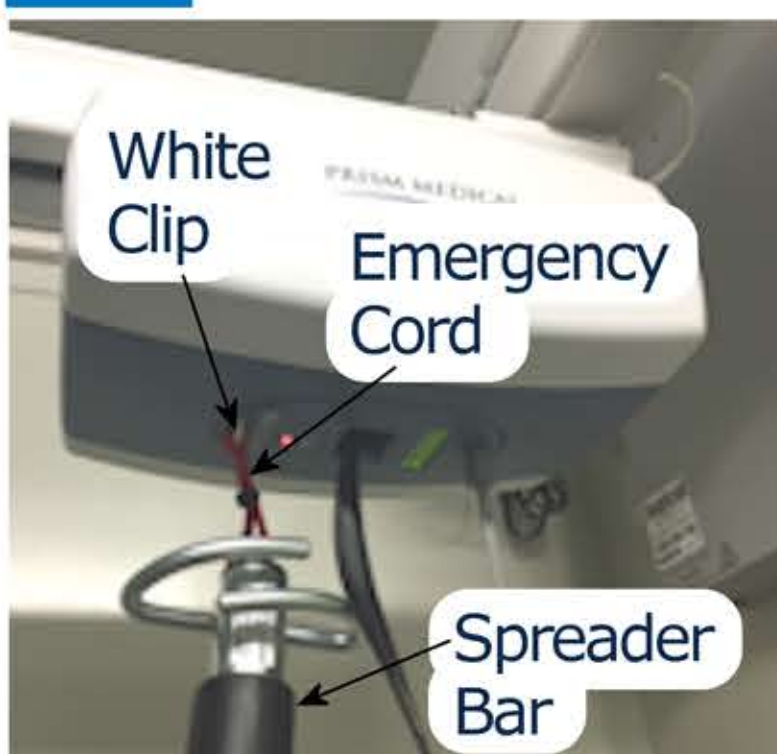

- If the hoist is not working, check to see if the red **Emergency Stop** cord has been pulled into the down position, disabling the hoist.
- **PULL AND HOLD EMERGENCY CORD TO LOWER HOIST IF REQUIRED**
- To re-enable hoist, push white clip attached to the top of the red **Emergency Stop** cord with your finger or use the end of the spreader bar to reach.

4 When you are finished...



Please always return the hoist to the charge position as shown, ready for re-use.